

- REV. 10-26-00: REDREW AND RENAMED SHEET. ELIMINATED USE OF CHANNEL KEYS AND ALL RELATED DETAILS. ELIMINATED DETAILS FOR HOOK BOLT JOINT.
- REV. 1-19-02: ADDED NEW GENERAL NOTE (B). REDESIGNATED ALL SUBSEQUENT GENERAL NOTES.

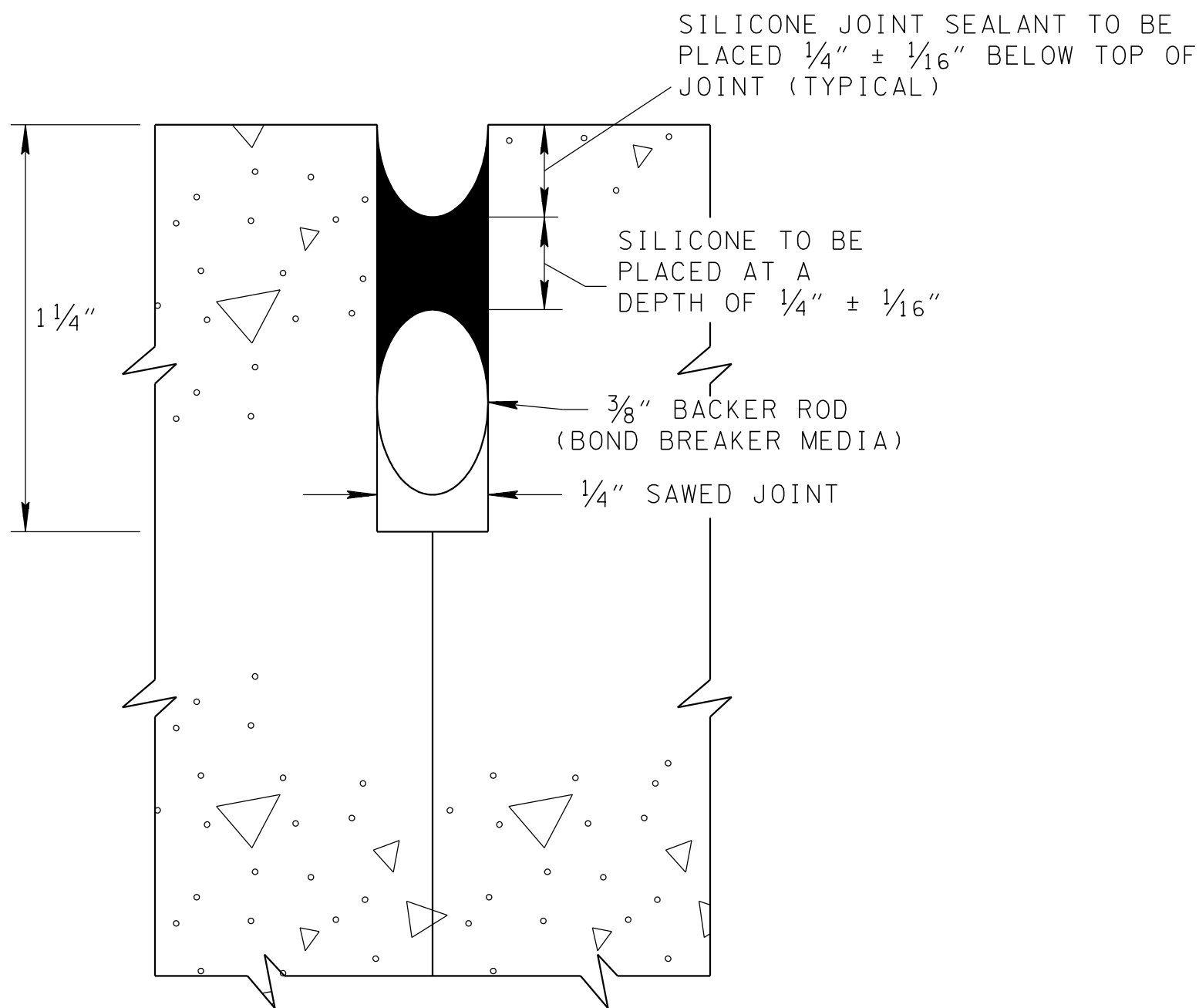

LONGITUDINAL CONSTRUCTION JOINTS

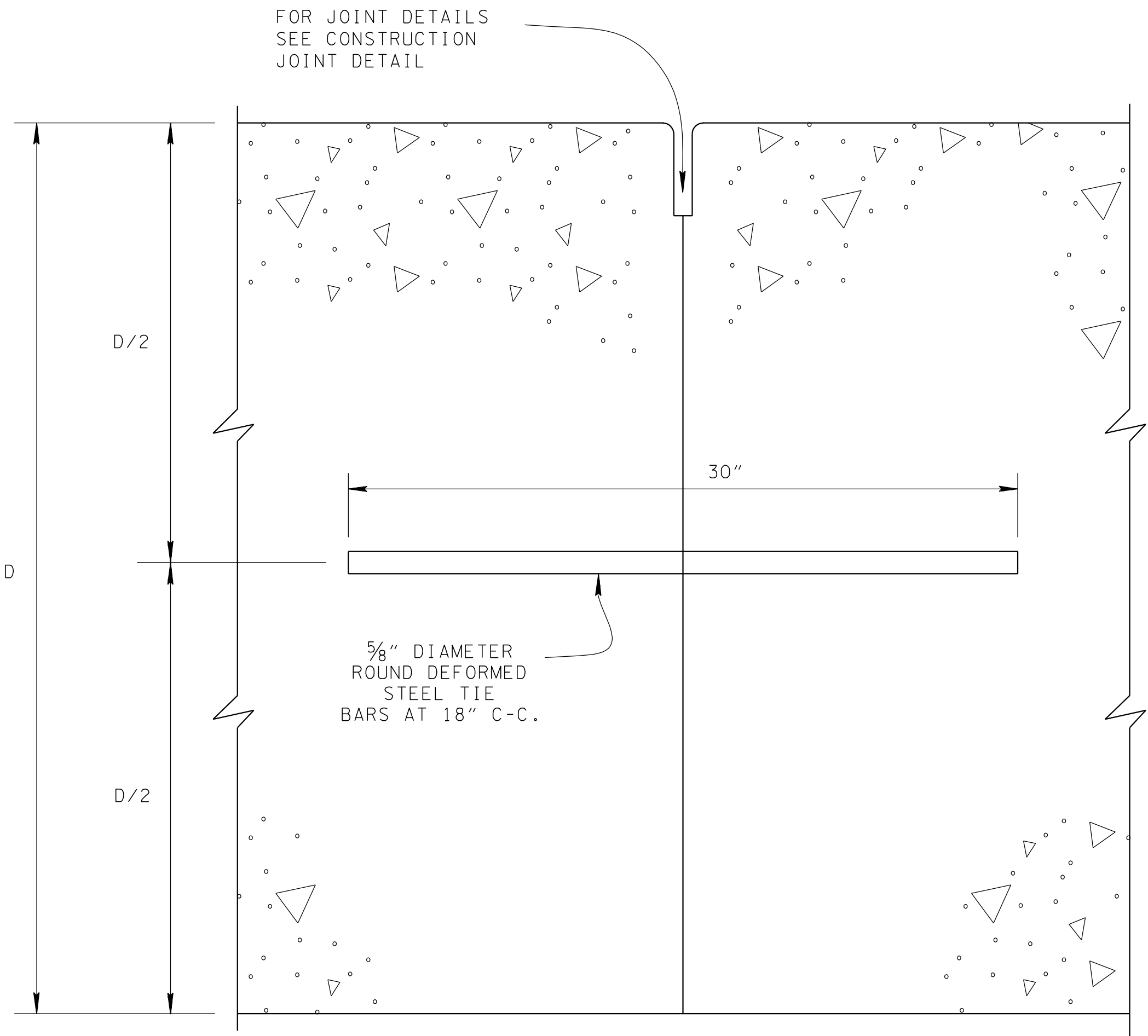

TIE BAR DETAIL FOR
LONGITUDINAL CONSTRUCTION JOINTS

FOR JOINT LOCATIONS SEE DRAWINGS
RP-J-1, RP-J-3, RP-J-5 AND RP-J-7.

GENERAL NOTES

- (A) LONGITUDINAL CONTRACTION AND/OR CONSTRUCTION JOINTS WITH TIE BARS SHALL BE REQUIRED.
- (B) LONGITUDINAL CONTRACTION AND/OR CONSTRUCTION JOINTS IN THE PORTLAND CEMENT CONCRETE SHOULDERS SHALL BE OF THE SAME TYPE, MATERIAL AND SPACING AS THE CORRESPONDING JOINTS IN THE PORTLAND CEMENT CONCRETE TRAFFIC LANES. (SEE SUBSECTION 501.23 (b) OF THE STANDARD SPECIFICATIONS.) SEE STANDARD DRAWINGS RP-CS-1 AND RP-CS-2 FOR FURTHER DETAILS.
- (C) TIE BARS SHALL BE 2'-6" LONG AND SPACED AT 1'-6" CENTER-TO-CENTER.
- (D) TIE BARS SHALL BE FIVE EIGHTS-INCH DIAMETER ROUND DEFORMED STEEL BARS AND CONFORM TO ASTM A615-GRADE 40 SPECIFICATIONS.
- (E) TIE BARS SHALL NOT BE PLACED WITHIN 15" OF TRANSVERSE CONTRACTION OR CONSTRUCTION JOINTS AND EXPANSION JOINTS.

CROSS-REFERENCE DRAWINGS FOR THIS
SHEET: RP-J-1,RP-J-3, RP-J-5,
RP-J-7 AND RP-J-9.

MINOR REVISION -- FHWA
APPROVAL NOT REQUIRED.

STATE OF TENNESSEE
DEPARTMENT OF TRANSPORTATION

LONGITUDINAL
CONTRACTION
AND
CONSTRUCTION JOINTS

7-29-98

RP-J-15